

PART A

Premises Licence

**Peterborough City Council, Environmental Services,
 Bridge House, Town Bridge, Peterborough, PE1 1HU**

Premises Licence Number

056816

Part 1 - Premises Details

Postal address of premises, or if none, ordnance survey map reference or description

Eastfield News
 32 Eastfield Road
 Eastfield

Post Town Peterborough

Post Code PE1 4AN

Telephone Number

Where the licence is time limited the dates

Start Date N/A
 End Date N/A

Licensable activities authorised by the licence

Sale by retail of alcohol

The supply of alcohol will be for consumption off the premises.

The times the licence authorises the carrying out of licensable activities

Sale by Retail of Alcohol

Monday to Sunday Between 06.00hrs and 00.00hrs

The opening hours of the premises

Monday to Sunday Between 06.00hrs and 00.00hrs

Where the licence authorises supplies of alcohol whether these are on and / or off supplies

The supply of alcohol will be for consumption off the premises.

Part 2

Name, (registered) address, telephone number and email (where relevant) of holder of premises licence

Mr Mohammed Tanveer
153 Cromwell Road
Peterborough
PE1 2EC

Registered number of holder, for example company number, charity number (where applicable)

N/A

Name, address and telephone number of designated premises supervisor where the premises licence authorises the supply of alcohol

Mr Mohammed Tanveer
153 Cromwell Road
Peterborough
PE1 2EC

Personal licence number and issuing authority of personal licence held by designated premises supervisor where the premises licence authorises for the supply of alcohol

Licence Number	045881
Issuing Authority	Peterborough City Council

Annex 1 - Mandatory conditions

Licensees should note that the under enclosed Mandatory conditions should be read in conjunction with the granted licence and these conditions shall be enforceable where relevant to the operation of the premise and its activities.

Supply of alcohol (Premises Licence)

This registration authorises the supply of alcohol subject to the following conditions:

1. No supply of alcohol may be made at a time when
 - (a) there is no designated premises supervisor in respect of the premises licence, or
 - (b) when the designated premises supervisor does not hold a personal licence or his personal licence is suspended.

2. Every supply of alcohol under the premises licence must be made or authorised by a person who holds a personal licence.

Annex 2 - Conditions consistent with the Operating Schedule

Crime and Disorder

3. The 'Challenge 21' initiative to prevent sales of alcohol to persons under 18 years of age will be implemented at the premises.
4. Signage will be prominently placed within the premises advertising the fact that the premises operates the 'Challenge 21' initiative.

Annex 3 - Conditions attached after a hearing by the licensing authority

BLANK

Annex 4 – Plans

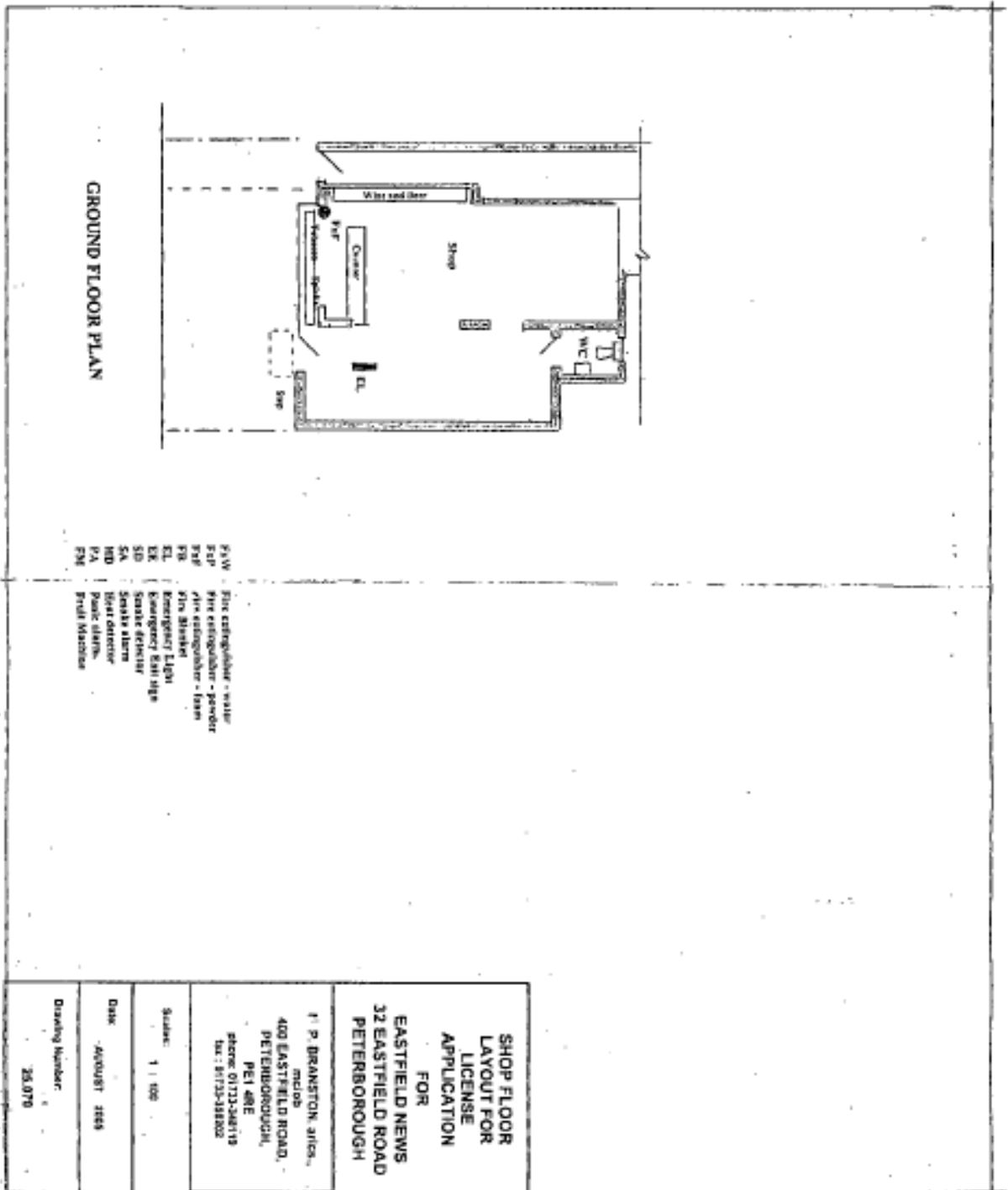

<p>SHOP FLOOR LAYOUT FOR LICENSE APPLICATION</p> <p>FOR EASTFIELD NEWS 32 EASTFIELD ROAD PETERBOROUGH</p>	<p>1 P. BRANSTON, archt. m.c.o.b. 400 EASTFIELD ROAD, PETERBOROUGH, PE1 4BE phone: 01733-348115 fax: 01733-358202</p>
<p>Scale: 1 : 100</p>	
<p>Date: 26/09/87 2449</p>	
<p>Drawing Number: 25.076</p>	

PART B

Premises licence summary

Peterborough City Council, Licensing Section,
 Bridge House, Town Bridge, Peterborough, PE1 1HU

Premises Licence Number

056816

Premises Details

Postal address of premises, or if none, ordnance survey map reference or description

Eastfield News
 32 Eastfield Road
 Eastfield

Post Town Peterborough

Post Code PE1 4AN

Telephone Number

Where the licence is time limited the dates

Start Date N/A
 End Date N/A

Licensable activities authorised by the licence

Sale by retail of alcohol

The supply of alcohol will be for consumption off the premises.

The times the licence authorises the carrying out of licensable activities

Sale by Retail of Alcohol

Monday to Sunday Between 06.00hrs and 00.00hrs

The opening hours of the premises

Monday to Sunday Between 06.00hrs and 00.00hrs

Where the licence authorises supplies of alcohol whether these are on and/ or off supplies

The supply of alcohol will be for consumption off the premises.

Name, (registered) address of holder of premises licence

Mr Mohammed Tanveer
 153 Cromwell Road
 Peterborough
 PE1 2EC

Registered number of holder, for example company number, charity number (where applicable)

N/A

Name of designated premises supervisor where the premises licence authorises for the supply of alcohol

Mr Mohammed Tanveer

State whether access to the premises by children is restricted or prohibited

Restricted